



LEADING WELLNESS THROUGH LIFESTYLE TRANSFORMATION

18-20 OCTOBER 2024
BITEC, BANGKOK THAILAND



Organised by: **fit**
Supported by: **TCEB**
THAILAND CONVENTION & EXHIBITION BUREAU

ASIA FITNESS CONFERENCE

Bangkok International Trade & Exhibition Centre

AFC 2024 is THE place to network with fitness professionals and enthusiasts, club and business owners/managers, healthcare professionals, wellness providers and leading brands in the industry.

พื้นที่แสดงสินค้าและบริการ ASIA FITNESS CONFERENCE 2024 ตั้งอยู่บริเวณชั้น 2

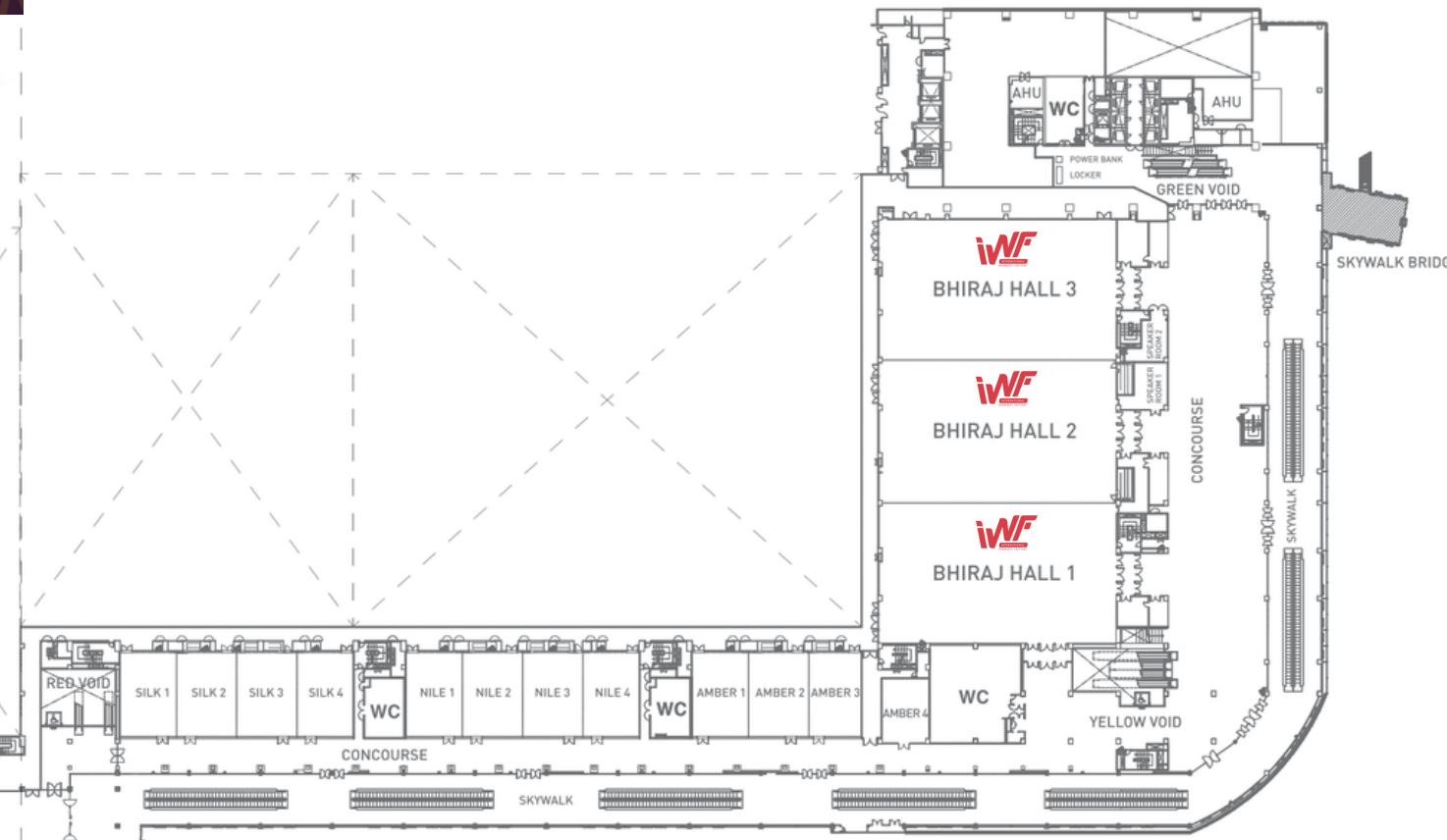
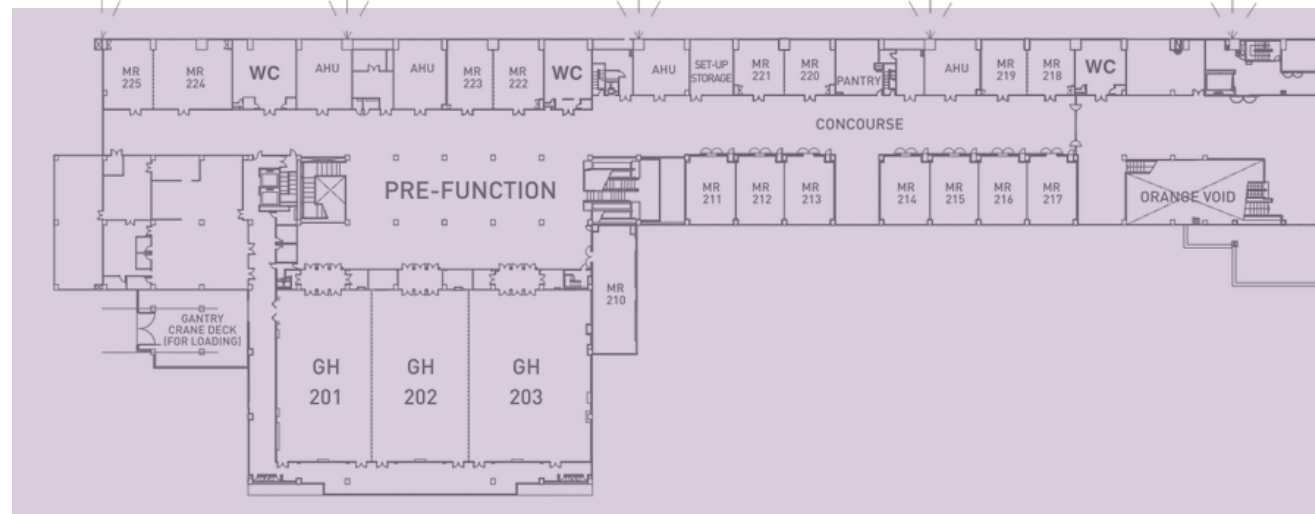



LEADING WELLNESS THROUGH LIFESTYLE TRANSFORMATION

18-20 OCTOBER 2024
BITEC, BANGKOK THAILAND



Organised by: **fit**
Supported by: **TCEB**

EXHIBITION OPPORTUNITIES

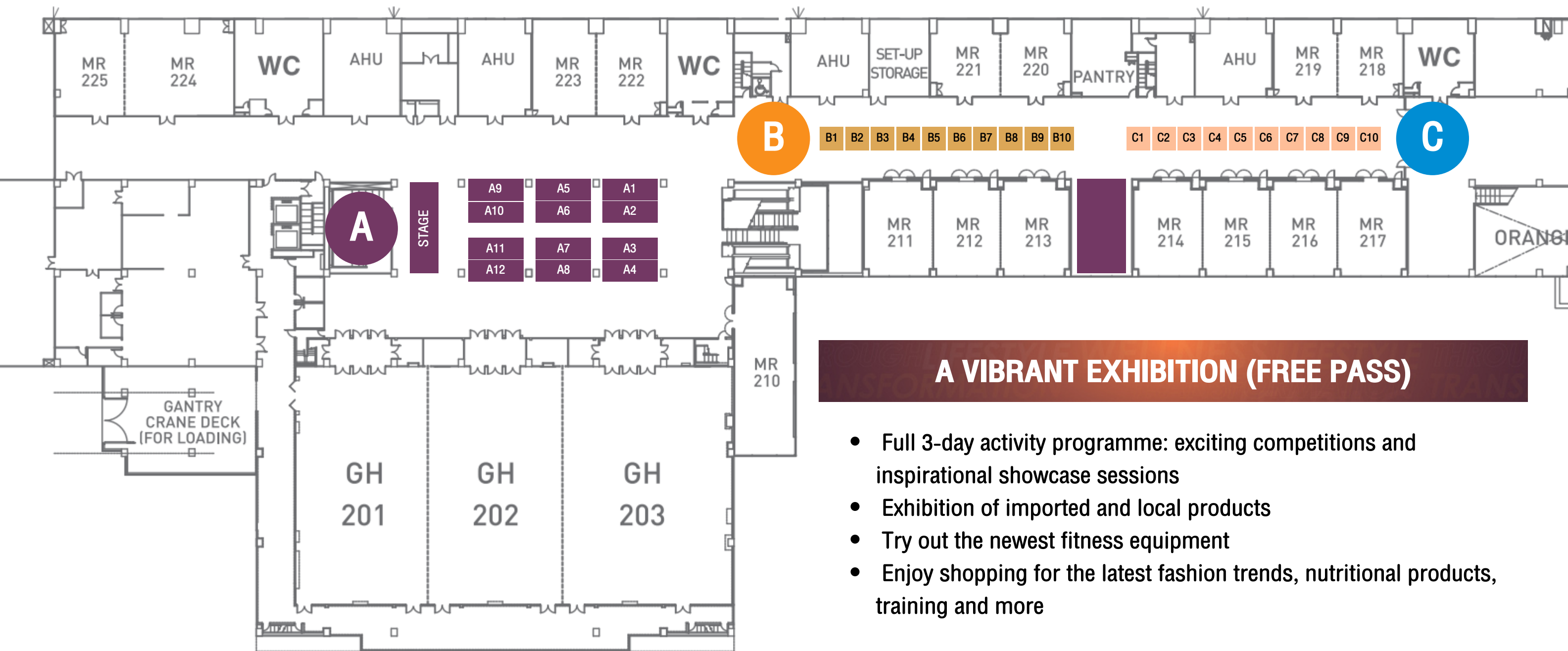

A VIBRANT EXHIBITION (FREE PASS)

- Full 3-day activity programme: exciting competitions and inspirational showcase sessions
- Exhibition of imported and local products
- Try out the newest fitness equipment
- Enjoy shopping for the latest fashion trends, nutritional products, training and more



LEADING WELLNESS THROUGH LIFESTYLE TRANSFORMATION

18-20 OCTOBER 2024
BITEC, BANGKOK THAILAND



Organised by: **fit**
Supported by: **TCEB**

EXHIBITION OPPORTUNITIES

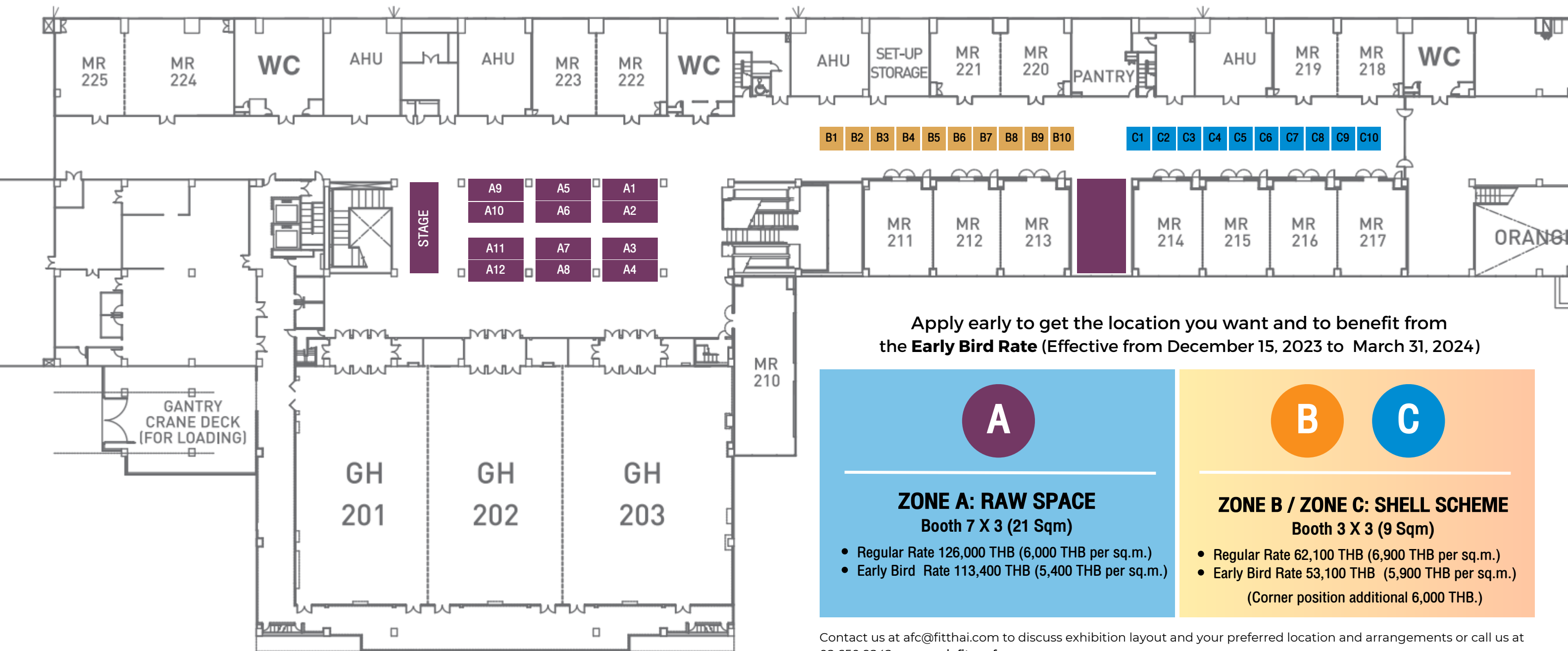

Apply early to get the location you want and to benefit from the **Early Bird Rate** (Effective from December 15, 2023 to March 31, 2024)

A

ZONE A: RAW SPACE
Booth 7 X 3 (21 Sqm)

- Regular Rate 126,000 THB (6,000 THB per sq.m.)
- Early Bird Rate 113,400 THB (5,400 THB per sq.m.)

B C

ZONE B / ZONE C: SHELL SCHEME
Booth 3 X 3 (9 Sqm)

- Regular Rate 62,100 THB (6,900 THB per sq.m.)
- Early Bird Rate 53,100 THB (5,900 THB per sq.m.)

(Corner position additional 6,000 THB.)

Contact us at afc@fitthai.com to discuss exhibition layout and your preferred location and arrangements or call us at 02 650 9242. www.asiafitconference.com



LEADING WELLNESS THROUGH LIFESTYLE TRANSFORMATION

18-20 OCTOBER 2024
BITEC, BANGKOK THAILAND



EXHIBITION OPPORTUNITIES

A 12 UNITS

ZONE A: RAW SPACE
Booth 7 X 3 (21 Sqm)

- Regular Rate 126,000 THB (6,000 THB per sq.m.)
- Early Bird Rate 113,400 THB (5,400 THB per sq.m.)

B C 20 UNITS

ZONE B / ZONE C: SHELL SCHEME
Booth 3 X 3 (9 Sqm)

- Regular Rate 62,100 THB (6,900 THB per sq.m.)
- Early Bird Rate 53,100 THB (5,900 THB per sq.m.)
(Corner position additional 6,000 THB.)

Apply early to get the location you want and to benefit from

EARLY BIRD RATE

(Effective from December 15, 2023 to March 31, 2024)

Contact us at afc@fitthai.com to discuss exhibition layout and your preferred location and arrangements
or call us at 02 650 9242. www.asiafitconference.com



**LEADING WELLNESS
THROUGH LIFESTYLE
TRANSFORMATION**
18-20 OCTOBER 2024
BITEC, BANGKOK THAILAND



EXHIBITION OPPORTUNITIES

A 12 UNITS

ZONE A: RAW SPACE

Booth 7 X 3 (21 Sqm)

- Regular Rate 126,000 THB (6,000 THB per sq.m.)
- Early Bird Rate 113,400 THB (5,400 THB per sq.m.)

21-square meter raw space booths (design your own booth width 3 meters x length 7 meters) located in the activity stage zone and in front of the main meeting room 201-203. under the terms of the organizer

Contact us at afc@fitthai.com to discuss exhibition layout and your preferred location and arrangements or call us at 02 650 9242.

www.asiafitconference.com





**LEADING WELLNESS
THROUGH LIFESTYLE
TRANSFORMATION**
18-20 OCTOBER 2024
BITEC, BANGKOK THAILAND



Organised by: **fit**
Supported by: **TCEB**

EXHIBITION OPPORTUNITIES

B 10 UNITS C 10 UNITS

ZONE B / ZONE C: SHELL SCHEME Booth 3 X 3 (9 Sqm)

- Regular Rate 62,100 THB (6,900 THB per sq.m.)
 - Early Bird Rate 53,100 THB (5,900 THB per sq.m.)
- (Corner position additional 6,000 THB.)

- 1 ELECTRICAL CONNECTION
- 1 TABLE
- 2 CHAIRS
- 1 GARBAGE BIN
- BOOTH WALLS
- CARPETING
- FASCIA BOARD

Contact us at afc@fitthai.com to discuss exhibition layout and your preferred location and arrangements or call us at 02 650 9242.

www.asiafitconference.com

